

Micro Blade Building Blocks

NOTES

- » The building blocks are made up of the extrusion, gear tray and lamps to the dimensions listed
- » The building blocks can be configured end to end and lighting types are interchangeable
- » The maximum extrusion length is 3600 mm (lengths can be joined, see `Components` on pages 62–63)
- » Customised configurations available upon request
- » Building block dimensions do not include endcaps. An endcap is 4 mm (see `Components` on pages 62–63)
- » Most products are dimmable upon request - please specify Switch Dim, DSI, DALI or 1-10 v
- » Daylight sensors & corridor functions are available
- » Every Blade job is manufactured to order. Production drawings will be issued for sign-off on ordering
- » Installation instructions are available for download on www.bladelighting.com

SURFACE FINISHES

- » Anodised
 - » Powder coated silver
 - » Powder coated white
- * Other finishes are available on request

FLUORESCENT DOWNLIGHT WITH PIGGY-BACK BALLAST FOR CONTINUOUS LIGHT

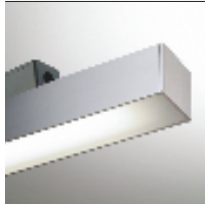

(x) overall length of building block (does not include endcap)	Wattage of T5 fluorescent lamps
580 mm	1 x 14w or 1 x 24w
880 mm	1 x 21w or 1 x 39w
1180 mm	1 x 28w or 1 x 54w
1480 mm	1 x 35w or 1 x 80w

EXAMPLE OF A BUILDING BLOCK COMPLETE WITH ENDCAPS PLAN VIEW

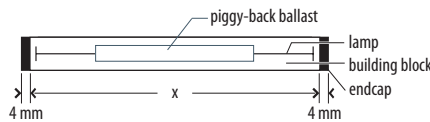

- » Piggy-back ballast dimensions: L 525mm, W 35mm, D 25mm
- » Supplied complete with ice diffuser
- » Not suitable for suspended applications
- » Also available with a remote ballast on a 500mm lead
- » Unless specified, colour temperature of lamps will be 4000 K

1 x 28w T5 (Downlight)

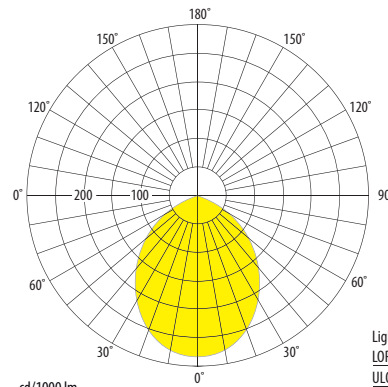

Utilisation Factors

Room Reflectance			Room Index								
Ceiling	Walls	Floor	.75	1.00	1.25	1.50	2.00	2.50	3.00	4.00	5.00
70	50	20	0.39	0.45	0.50	0.53	0.57	0.60	0.62	0.64	0.66

SHR Nom = 1.25 SHR Max = 1.47

- » Photometric data is available for download on www.bladelighting.com

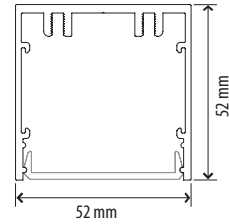

FLUORESCENT UPLIGHT OR DOWNLIGHT WITH INTEGRAL BALLAST

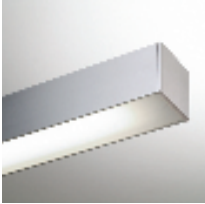

» Unless specified, colour temperature of lamps will be 4000 K

1 x 28w T5 (Downlight)

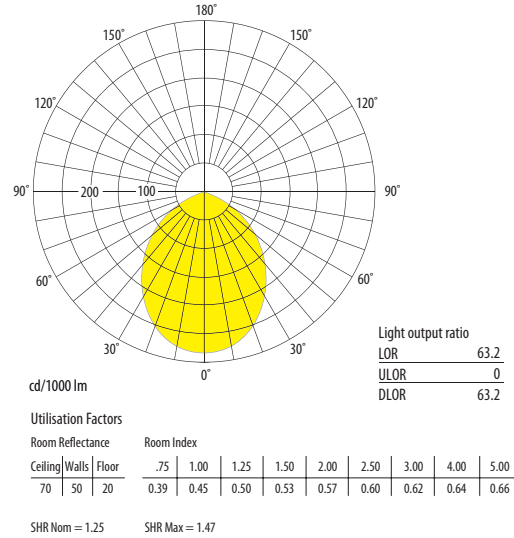

#1 EXAMPLE OF A SINGLE BUILDING BLOCK COMPLETE WITH ENDCAPS PLAN VIEW

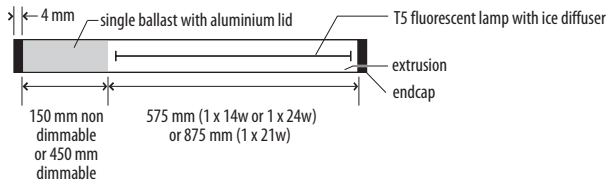

#2 EXAMPLE OF A SINGLE BUILDING BLOCK COMPLETE WITH ENDCAPS PLAN VIEW

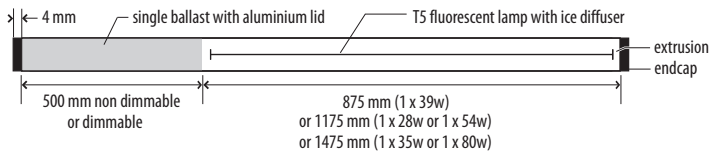

#3 EXAMPLE OF A DOUBLE BUILDING BLOCK COMPLETE WITH ENDCAPS PLAN VIEW

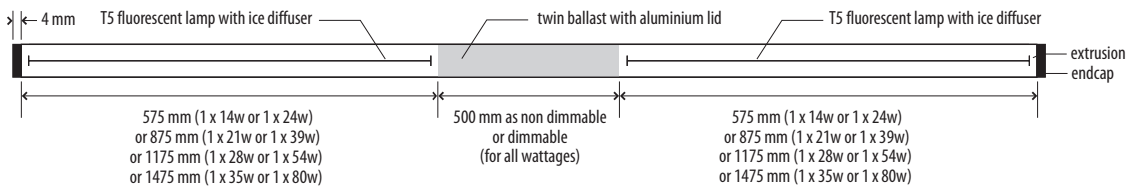

» Photometric data is available for download on www.bladelighting.com

MR11 HALOGEN DOWNLIGHT

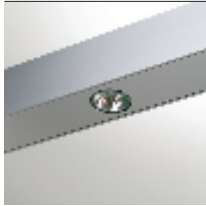

MINIMUM SPACE REQUIREMENT

The minimum space requirement for an aluminium back MR11 Downlight is 400 mm

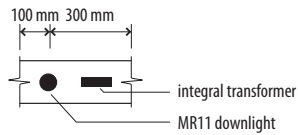

EXAMPLE OF A BUILDING BLOCK COMPLETE WITH ENDCAPS
3 x MR11 DOWNLIGHTS

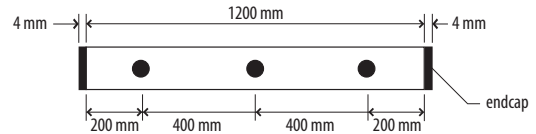

- » With minimum space requirements in mind, an MR11 downlight can be spaced according to your requirements
- » Unless specified, MR11 lamp will be 35w 36°

LED DOWNLIGHT



MINIMUM SPACE REQUIREMENT

The minimum space requirement for twin LED Downlights is 400 mm

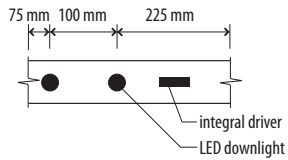

EXAMPLE OF A BUILDING BLOCK COMPLETE WITH ENDCAPS
2 x Twin LED Downlights

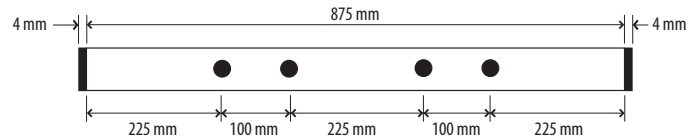

- » With minimum space requirements in mind, an LED downlight can be spaced according to your requirements
- » Unless specified, 1w LED lamp will be supplied in cool white

JAC SPOTLIGHT



MINIMUM SPACE REQUIREMENT – 1 x JAC SPOT

The minimum space requirement for a JAC spotlight is 400 mm

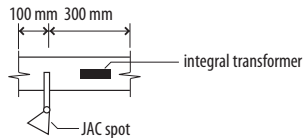

MINIMUM SPACE REQUIREMENT – 2 x JAC SPOT

The minimum space requirement for 2 x JAC spotlights is 500 mm

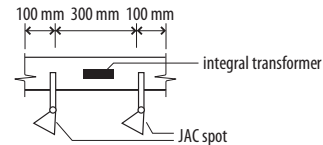

- » Various spotlights available
- » With minimum space requirements in mind, a JAC spotlight can be spaced according to your requirements

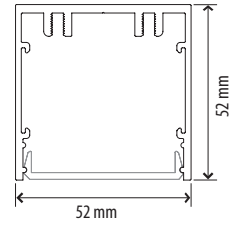

Wall or Ceiling Lights

MICRO HANDLE



MICRO HANDLE 680/980
Ceiling or wall mounted, T5 fluorescent lamp

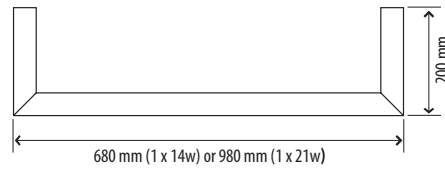

MICRO HANDLE 1280/1580
Ceiling mounted, T5 fluorescent lamp

